

PERKO[®]

Thru-Hull Connection Molded White Plastic Narrow Flange

Marine U.L. Listed

Package 10, 1 per card

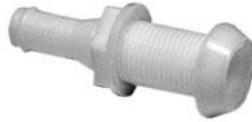

ORDER NO.	MAXIMUM HOSE SIZE	HULL THICKNESS	O.D.	PRICE
PER 0301DP4	1/2"	1-1/4"	1 1/4	\$5.37

SEADOG Thru-Hull

316 Cast Stainless

Mirror polished face. Includes grounding stud.

NEW



ORDER NO.	HOSE SIZE	PRICE
SDG 520811	1/2"	\$19.95
SDG 520812	3/4"	\$21.25
SDG 520813	1"	\$26.25
SDG 520814	1-1/4"	\$32.95
SDG 520815	1-1/2"	\$46.95

PERKO[®]

Thru-Hull Connections

Flange is machined to fit hull and grooved to retain bedding compound. Neck is threaded to approximately 3/8 inch from flange.

Marine U.L. Listed



Plain Bronze

ORDER NO.	HOSE	MAXIMUM HULL THICKNESS	O.D.	PRICE
PER 0350004DPP	5/8	1-1/16"	1-1/2	\$29.19
PER 0350005DPP	3/4	1-5/8"	1-7/8	\$41.79
PER 0350006DPP	1	1-3/4"	2-1/4	\$61.71
PER 035006ADPP	1-1/8	1-3/4"	2-1/4	\$55.09
PER 0350007DPP	1-1/4	1-7/8"	2-3/4	\$65.36
PER 0350008DPP	1-1/2	1-7/8"	3-1/8	\$84.04

Chrome Plated Bronze

ORDER NO.	HOSE	MAXIMUM HULL THICKNESS	O.D.	PRICE
PER 0350004DPC	5/8	1-1/16"	1-1/2	\$34.34
PER 0350005DPC	3/4	1-5/8"	1-7/8	\$47.02
PER 035006ADPC	1-1/8	1-3/4"	2-1/4	\$61.82
PER 0350009CHR	2	2	3-3/4	\$133.90

PERKO[®]

Thru-Hull Connections Cast Bronze

Flange is machined to fit hull and grooved to retain bedding compound. Neck is threaded to approximately 3/8 Inch from flange.

Marine U.L. Listed



ORDER NO.	PIPE SIZE	MAXIMUM HULL THICKNESS	O.D. FLANGE	PRICE
PER 0322DP4PLB	1/2"	1-3/8"	1-1/2"	\$33.85
PER 0322DP5PLB	3/4"	1-1/2"	1-7/8"	\$34.96
PER 0322DP6PLB	1"	1-7/8"	2-3/16"	\$47.74
PER 0322DP7PLB	1-1/4"	2"	2-3/4"	\$72.14
PER 0322DP8PLB	1-1/2"	2-1/4"	3"	\$87.69
PER 0322009PLB	2"	2-3/8"	3-5/8"	\$115.67

Extra Long

ORDER NO.	PIPE SIZE	MAXIMUM HULL THICKNESS	O.D. FLANGE	PRICE
PER 0348DP5PLB	3/4"	5"	1-7/8"	\$64.21
PER 0348DP6PLB	1"	4-7/8"	2-1/4"	\$68.17

attwood[®] Thru-Hull Connectors Rugged Stainless Construction

- Cast from certified #316 Stainless Steel alloy for strength and life time corrosion resistance.
- We polish all visible areas to a mirror finish, then send each part through passivation for additional protection.
- Thick steel sidewalls withstand continual stress and hose flexing

ORDER NO.	SIZE	PRICE
ATT 665463	5/8"	\$20.99
ATT 665473	3/4"	\$24.18
ATT 665483	1"	\$28.20
ATT 665493	1-1/8"	\$33.74
ATT 665503	1-1/4"	\$40.06
ATT 665513	1-1/2"	\$49.07



attwood[®]

Molded of tough acetal resin plastic. Will not rust, corrode, discolor or, because they're nonmetallic, contribute to electrolysis. Special design reduces hull streaking, also allows counter-sinking wherever a flush fit is required.



Hose I.D.: 5/8".
Stem length: 3-1/4".
Maximum hull thickness: 1-1/2".
Flange diameter: 1-1/4".
Installation hole diameter: 1-1/8".

Hose I.D.: 3/4".
Stem length: 3-1/4".
Maximum hull thickness: 1-1/2".
Flange diameter: 1-1/4".
Installation hole diameter: 1-1/8".

ORDER NO.	PRICE
ATT 38721	\$2.49

Hose I.D.: 1-1/2".
Stem length: 3-1/2".
Maximum hull thickness: 1-1/2".
Flange diameter: 3".
Installation hole diameter: 2".

Hose I.D.: 1-1/8" to 1-1/4".
Stem length: 3-1/4".
Maximum hull thickness: 1-3/8".
Flange diameter: 2-1/4".
Installation hole diameter: 1-3/8".

ORDER NO.	PACKAGING	PRICE
ATT 38733	Skin Pack	\$4.01
ATT 38731	Bulk	\$2.49

ORDER NO.	PRICE
ATT 38751	\$6.73

ORDER NO.	PACKAGING	PRICE
ATT 38743	Skin Pack	\$6.28
ATT 38741	Bulk	\$4.68

PERKO[®]

Thru-Hull Connection Molded White Plastic

Marine U.L. Listed

Broad Flange



ORDER NO.	HOSE	MAXIMUM HULL THICKNESS	O.D. FLANGE	PRICE
PER 0328DP4	1/2	1-1/4"	1-1/2"	\$4.85
PER 0328DP4A	5/8	1-1/4"	1-1/2"	\$4.84
PER 0328DP5	3/4	1-7/16"	1-7/8"	\$5.17
PER 0328DP6	1	1-1/2"	2-1/4"	\$10.37
PER 0328DP6A	1-1/8	1-1/2"	2-1/4"	\$10.38
PER 0328DP8	1-1/2	1-7/8"	3"	\$13.95